

Instructions

Mist AP20 All the Way to Paris 2025

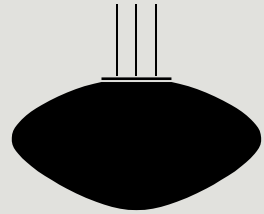

Please read these instructions carefully and retain them for future reference to ensure the product is used correctly. For your own safety, please study each step of this instruction manual first. &Tradition is not responsible for any faults or damage caused by not following these instructions correctly. Do not modify this product in any way. If you have any questions or comments, please do not hesitate to contact us by mail on: info@andtradition.com

Mist AP20

All the Way to Paris 2025

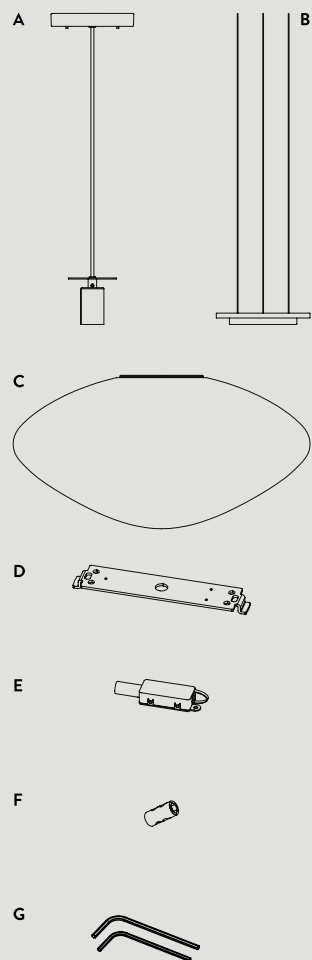

02/25

For indoor use only
E27 maximum 12W LED only
Bulb not included



Safety precautions

- Dispose of plastic bag from packaging and do not allow children to play with it.
- Read through the following instructions carefully before installation.
- A minimum of two or more people are required for installation.
- The lamp is intended for indoor use only.
- Ensure your ceiling can hold the weight of 10kg.
- If the internal cable or light source of this lamp is damaged, it must be replaced by the manufacturer or a qualified individual.
- If in any doubt, consult a professionally qualified electrician.

Contents

- A** Canopy and lamp holder
- B** Connection plate (inc. x 3 wires)
- C** Glass shade
- D** Bracket
- E** Terminal box
- F** Wire stopper x 3
- G** Allen key x 2

Tools needed

- Screw driver
- Wire cutter
- Screws and plugs suitable for ceiling type

Cleaning instructions

Wipe the surface of the lamp with a soft, damp sponge or cloth wrung in warm water. Do not use strong cleaning agents such as white spirit, turpentine, household glass cleaner or cellulose thinners. Never use any abrasive cleaning tools such as steel wool, scouring sponges or stiff brushes as these will damage the surface of the lamp. Only wipe the inside of the shade with a soft, damp cloth or feather duster.

Step 1 / 7

Turn off main electricity supply before installation.

Measure from the ceiling to identify the desired hanging height, and adjust the cord in the canopy (A) accordingly by loosening the strain relief.

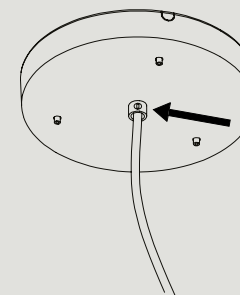

Step 2 / 7

Feed the wires from the connection plate (B) through the canopy (A) and make sure the lamp holder (A) can rest on top of the connection plate (B) as shown.

The wires can be adjusted by pressing the rivets on the canopy and pulling the wire out. Make sure that there is enough wire to adjust the hanging height after installation.

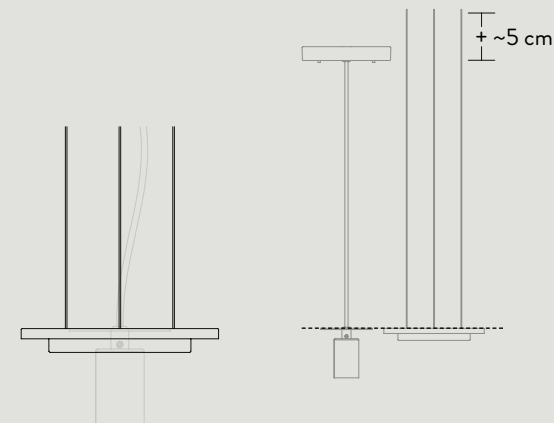

Step 3 / 7

To ensure the safety of the product, install wire stops (F) onto the wires once they are cut to length and adjusted.

Make a loop with the wire stops as shown and fasten the screws.

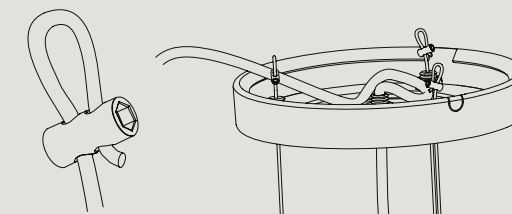

Step 4 / 7

Measure and mark the ceiling using the screw holes of the bracket (D) to install using screws and plugs suitable for your ceiling type.

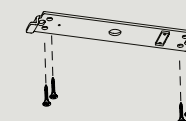

&Tradition®

&Tradition®

Step 5 / 7

Use the terminal box (E) to connect the lamp cords to the supply cords as shown.

Connect the cables to the terminal boxes, L to L and N to N.

Install the canopy (A) onto the bracket (D) by aligning and twisting.

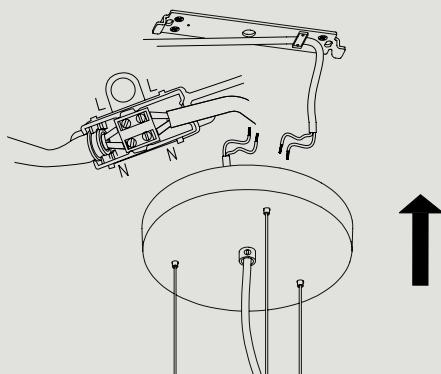

Step 6 / 7

To install the glass shade (C), lift and hold the shade up to the the threading on the connection plate (B) and twist until the glass has reached the metal part.

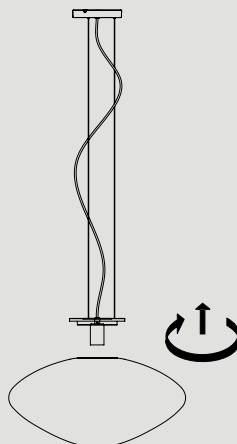

Step 7 / 7

To install a light source, lift the lamp cord and lamp holder to access the socket.

