

Instructions

Mist AP22 &Tradition 2025

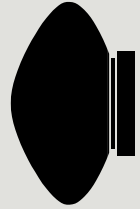

Please read these instructions carefully and retain them for future reference to ensure the product is used correctly. For your own safety, please study each step of this instruction manual first. &Tradition is not responsible for any faults or damage caused by not following these instructions correctly. Do not modify this product in any way. If you have any questions or comments, please do not hesitate to contact us by mail on: info@andtradition.com

Mist AP22 &Tradition 2025

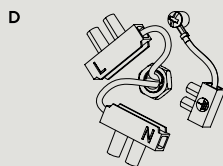
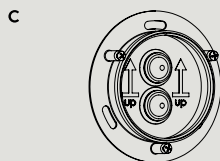
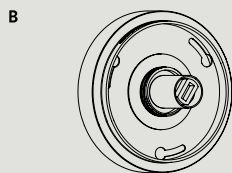
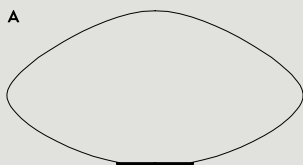

Safety precautions

- Dispose of plastic bag from packaging and do not allow children to play with it.
- Read through the following instructions carefully before installation.
- If in any doubt, consult a professionally qualified electrician.
- Turn off main power supply before installation.
- The product is suitable for both indoor and outdoor use.
- The product should only be installed in the orientation illustrated.

Contents

- A Glass shade
- B Cover
- C Bracket
- D Terminals x 3 (Inc. on cover)

Tools needed

- Philips screwdriver
- Small flat-head screwdriver

Cleaning instructions

Wipe the surface of the shade with a soft, dry cloth. Do not use any abrasive cleaning tools such as steel wool, scouring sponges or stiff brushes as this will damage the surface of the shade. Do not use strong cleaning agents such as white spirit, turpentine, household glass cleaner or cellulose thinners.

11/24

For indoor and outdoor use

G9 maximum 5W

Bulb not included



&Tradition®

Step 1 / 5

Align supply cord from wall or ceiling with the grommet on the bracket (C).

Mark the wall using the screw holes.

Puncture the grommet and feed the supply cord through it. Fasten the bracket to the wall.

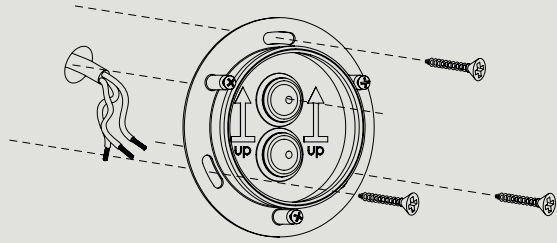

Step 2 / 5

Use the terminals (D) to connect the lamp cords to the supply cords as shown.

Connect cables to the terminal boxes, **use one for** L to L, N to N and \oplus to \oplus

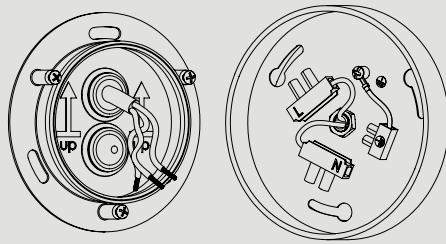

Step 3 / 5

Place the cover (B) over the bracket and turn clockwise. Fasten the screws to secure the cover.

Make sure that the cover applies even pressure on the bracket to ensure a tight seal.

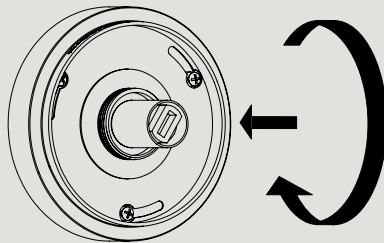

Step 4 / 5

Insert a light source into the socket.

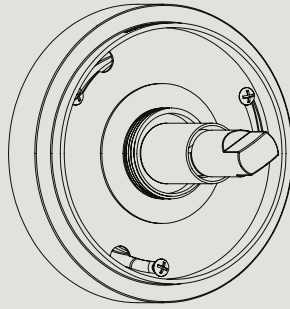

andtradition.com

Step 5 / 5

Place the glass shade (A) over the base and turn clockwise. Securely fasten against the silicon on the base to ensure a tight seal.

