

Instructions

Trace Cabinet SC87-SC88 Space Copenhagen 2023

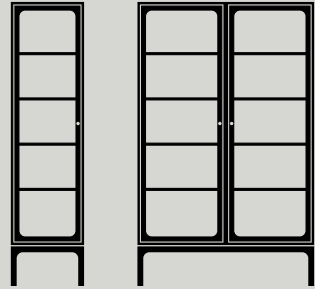

Please read these instructions carefully and retain them for future reference to ensure that the product is used correctly. For your own safety, please study each step of this instruction manual first.

&Tradition is not responsible for any faults or damages caused by not following these instructions correctly. Do not modify this product in any way. If you have any questions or comments, please do not hesitate to contact us by mail on: info@andtradition.com

&Tradition®

Trace Cabinet SC87-SC88 Space Copenhagen 2023

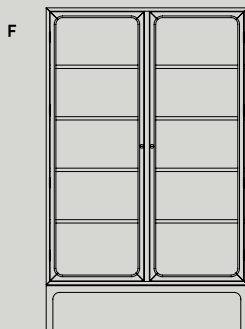

Safety precautions

It is very important that the cabinet is attached firmly to the wall to prevent it from falling over. &Tradition does not supply screws for wall mounting. Please make sure to use the correct type of screws and dowels for your specific wall. If the cabinet/credenza is standing freely without attachment, there is a big risk that it can fall over. Do not let the cabinet stand freely.

Do not move the cabinet on the legs. The cabinet must be lifted from the floor when moved, to prevent damage to the legs.

Contents

- A Door Knob(s) *
- B Screw(s) for bracket(s) *
- C Bracket(s) *
- D Allen Key
- E Single door cabinet
- F Double door cabinet
- Dowels for wall mounting **
- Screws for wall mounting **

*Two knobs, screws and brackets are provided for the double door cabinet

**Provide own dowels and screws suitable for your wall type

Tools needed

- Screwdriver
- Drill

Cleaning instructions

Lacquered or Stained Wood

For daily care it is recommended to dust the furniture with a soft cloth. Lacquered and stained wood can be cleaned with a soft cloth wrung in a mild solution of lukewarm water and a universal cleaning detergent. Always follow the wood grains and always dry with a soft dry cloth immediately after cleaning.

Avoid use of abrasive cleaning agents and aggressive cleaning detergents as this will damage the surface of the lacquered or stained wood. Avoid placing wooden furniture in direct sunlight, excessive heat or humidity.

Brass

For daily cleaning of coated brass and copper it is recommended only to use a soft dry, cloth. For removal of stains, a soft cloth wrung in lukewarm water can be carefully applied. Always dry immediately after with a soft dry cloth. For daily cleaning of uncoated brass and copper it is recommended only to use a soft, dry cloth. In case a patina of the material is not desired, the material can be regularly cleaned and polished using a detergent specifically for brass and copper.

Glass

Daily cleaning of glass is best done using a soft, dry cloth. If more severe cleaning is necessary, it is recommended to use a soft cloth with a standard glass cleaning detergent and then to follow by drying with a soft, dry cloth. Avoid using abrasive cleaning agents on the glass as this will damage the surface.

Please follow steps 1-6 to assemble the product.

Step 1 / 6

Attach the doorknob(s) firmly to the door.

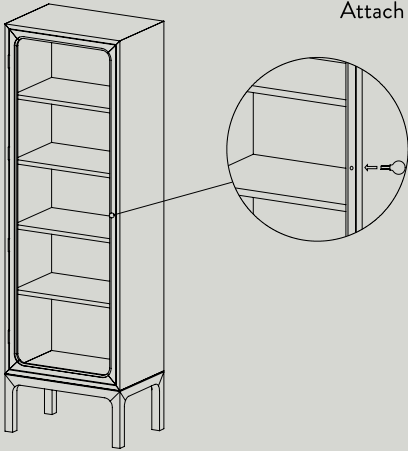

Step 2 / 6

When placing the cabinet on the floor, the gap around the doors might be a bit uneven. This is caused by the cabinet not standing level.

This can be improved by adjusting the feet on the cabinet. To adapt the height, turn the screw located at the back of the cabinet feet using an Allen key. You may need to adjust the feet on multiple legs to achieve optimal results.

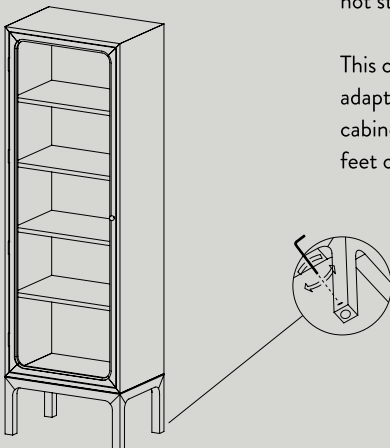

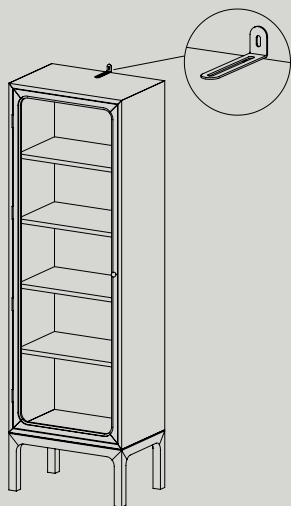

Step 3 / 6

When the cabinet is positioned as it should, place the bracket over the bushing and press it up to the wall.

Drill in the wall and insert wall plug (plug and wall screw is not supplied).

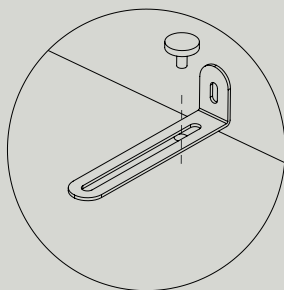

Step 4 / 6

Insert the fingerscrew into the bushing in the cabinet.

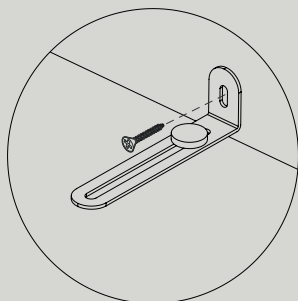

Step 5 / 6

Fasten the cabinet to the wall using own screw.

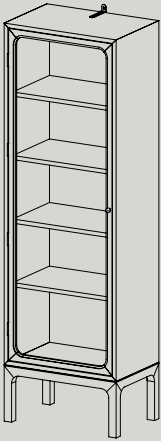

Step 6 / 6

Cabinet is now attached to the wall and safe to use.
Enjoy your product.

